

**DAVID A.
STRAZ, JR.
CENTER FOR THE
PERFORMING
ARTS**

**CAROL MORSANI
HALL**

TECHNICAL INFORMATION

Revised September 18, 2014

DAVID A. STRAZ, JR. CENTER FOR THE PERFORMING ARTS THE STRAZ CENTER

MAILING ADDRESS: 1010 NORTH W.C. MACINNES PLACE
TAMPA, FLORIDA 33602-3720

SHIPPING ADDRESS: 1010 NORTH W. C. MACINNES PLACE
TAMPA, FLORIDA 33602-3720

TELEPHONE: (813) 222-1000 (Administration)
(813) 222-4897 (Facsimile Number)
(813) 229-STAR (Box Office Number)
(813) 222-1082 (TDD Number)

ARCHITECT

Design Team Arcop from Toronto, Ontario, Canada
Design Arts Group from Tampa, Florida

DAVID A. STRAZ, JR. CENTER FOR THE PERFORMING ARTS

The Center is located along the east bank of the Hillsborough River in downtown Tampa, and provides an environment for a wide variety of attractions and concerts.

It is the largest performing arts complex south of the Kennedy Center in Washington, D.C.. The \$57 million, 290,000 - square foot building is made up of four separate theaters.

The performing spaces in the complex can easily accommodate major musicals, dance, theatrical and television productions, as well as an assortment of events such as awards programs, films, pageants, conventions, and meetings.

LOCATION

The David A. Straz, Jr. Center for the Performing Arts is located at 1010 North W. C. MacInnes Place, which is one block west of Ashley Street. The Center is just south of I-275 and north of the Tampa Library, at the west end of Fortune and Tyler Streets.

FROM ST. PETERSBURG: I-275 north and cross Tampa Bay via the Howard Franklin Bridge. Exit I-275 at the Downtown-West exit (exit #44).

FROM NORTH & CENTRAL CLEARWATER: Take U.S. 19 to Gulf-to-Bay (U.S. 60), go east. Cross Tampa Bay via the Courtney Campbell Causeway and follow signs to I-275 North, Exit I-275 at the Downtown-West exit (exit #44).

FROM SOUTH CLEARWATER: Take U.S. 19 to Ulmerton Road. Follow Ulmerton to I-275 North. Cross Tampa Bay via the Howard Franklin Bridge. Exit I-275 at the Downtown-West exit (exit #44).

FROM SARASOTA/VENICE: Take I-75 north and exit at I-4 west, Follow I-4 west to Tampa and take I-275 south at the divide. Exit I-275 at the Downtown-West exit (exit #44), which is immediately past the divide.

FROM ORLANDO: Follow I-4 to Tampa and take I-275 south at the divide. Exit I-275 at the Downtown-West exit (exit #44), which is immediately past the divide.

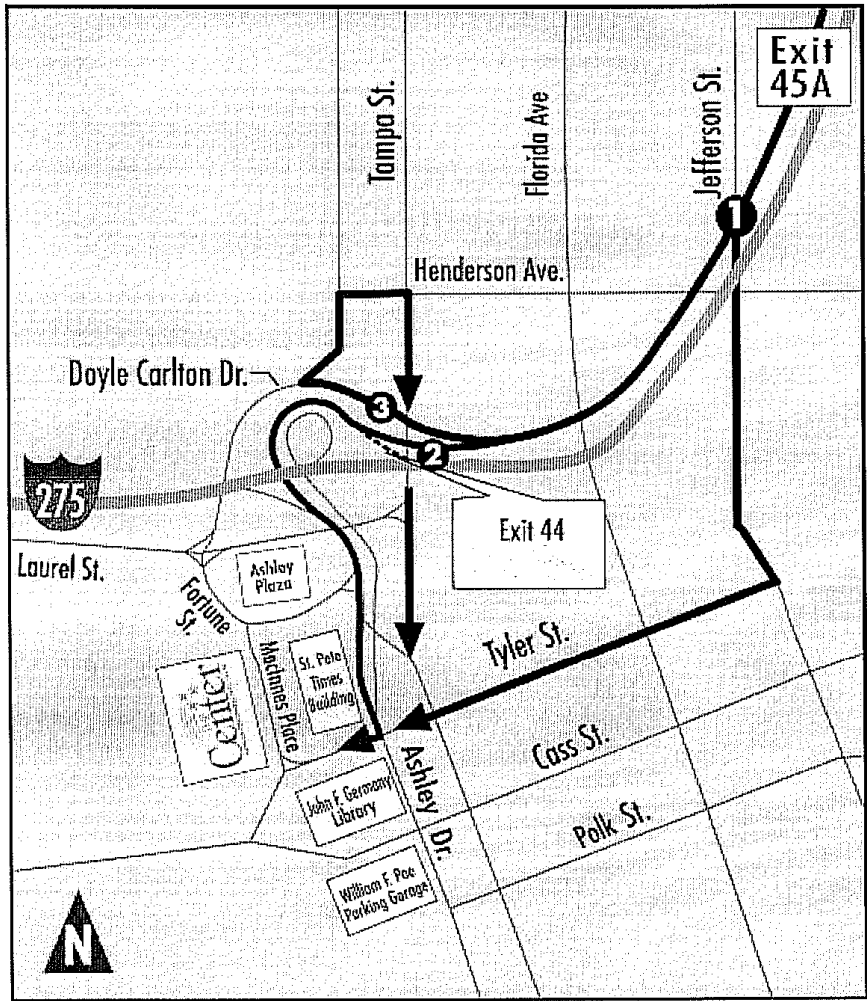

HOUSE RULES

Welcome to the Straz Center. We sincerely hope you have a pleasant and positive visit. Our staff will make every effort to accommodate your needs so that your production runs smoothly. Our staff is here to help you in any way possible. You can help us by observing to the following house rules:

1. Food and drinks are NOT permitted on stage. The exceptions are the Jaeb Theater when in cabaret configuration and for certain types of shows the Center deems appropriate. Smoking is never allowed in any theater.
2. The stage availability is scheduled through the company's stage manager, director, or designated representative. When the crew is on a meal break the stage is NOT available. Please do not enter the stage when it is dark. As soon as the crew returns the stage will be made available. If there are any questions regarding the schedule for stage availability please consult your stage manager, director, or a member of the Center's production staff.
3. The loading dock area may be used as a crossover to the Ferguson and Jaeb stage. Please do not rehearse or congregate in the area, as the noise is heard throughout the theaters. Please stay within the marked path and do not wander. If a show is loading in or out please use the crossover on the second floor. If you have any questions please ask security for directions.
4. Please confine your production to your designated theater and it's support areas. This is a large facility and frequently productions occur simultaneously. Our intention is to prevent unnecessary interruptions or awkward situations.
5. Parking is not permitted in the loading dock area or in front of the loading dock doors. It is designated for loading and unloading only. If you are unloading items from your car please do so and then move the car to one of the nearby parking lots.
6. For security purposes we ask that you enter and exit through the STAGE DOOR ONLY.
7. If you expect to meet friends or relatives after a performance direct them to the stage door only. Exceptions may be made available on a case by case basis. Please consult the production staff.
8. The wardrobe room is for costume use only. Personal laundry is not permitted.
9. DO NOT climb onto or jump off of the stage apron. We will be happy to direct you to stairs leading into the auditorium.
10. Please avoid touching or holding onto the stage drapes.
11. Please do not place objects upon the pianos--covered or uncovered.
12. Consult the head electrician before plugging any equipment into the receptacles.
13. Please do not remove chairs from the dressing rooms. We will supply you with any chairs you need.
14. Please do not use adhesive labels on dressing room doors or mirrors.
15. Alcoholic beverages are not to be brought into the building.
16. Check all valuables with your stage manager—the Center can not be responsible for property left in the dressing rooms.

If you have any questions or requests please feel free to consult a member of the production staff.

RULES AND REGULATIONS GOVERNING THE USE OF THE DAVID A. STRAZ, JR. CENTER FOR THE PERFORMING ARTS

GENERAL

1. Decoration or signs shall not be placed in any rooms, hallways, lobbies, or theaters in the building without the permission of the management. Any damages incurred by the violation of this rule will be paid by the party responsible for the damage.
2. No sign or decoration is allowed on the building exterior or sidewalk.
3. The visiting company shall not obstruct any portion of the sidewalks, entries, hallways, elevators, stairs, or other egress from the building including access to all building utilities.
4. Smoking is not permitted in the building. Florida is a smoke free State.
5. Animals (other than seeing eye dogs) will not be allowed in the facility for any reason other than use in the show and only during rehearsal and/or performance. This privilege must be secured through the Production Mgr. prior to load-in and can not be altered under any circumstances.

PRODUCTION RELATED

1. The visiting company shall provide identification and/or complete lists of all persons to be allowed in the backstage area. This list must be provided at load-in time. The Straz Center reserves the right to restrict backstage access.
2. The house opens 30 minutes prior to scheduled show time. All set-up and sound checks must be completed by this time. The Production Staff will assist the visiting company in opening the house on time.
3. Under no circumstance will the performance begin or the intermission end without the express direct verbal approval from The Straz Center's event Production Representative to the stage manager of the visiting company.
4. The Straz Center will provide space behind orchestra level seating to the extreme right and/or left of the sound control console. Please clear in advance with the Production Manager so that disabled seating can be removed in the appropriate areas. A snake 250' in length is necessary to reach the proscenium edge from the standard mix position.
5. The management reserves the right to control final sound level for any show in The Straz Center's theaters.
6. All coordination between the visiting company and the House staff will be done through the Production Staff with the exception of hard concessions.
7. The Straz Center maintains 24-hour security on all areas under its jurisdiction. No additional locks will be permitted on any door of the premises. It is recommended that valuables be collected by the visiting company's Stage Manager prior to the show and kept until the performance is completed. The Straz Center assumes no responsibility for valuables left in the dressing rooms.
8. Any use of pyrotechnics, open flame, and/or smoke or fog will require the services of a Fire Marshal on site. It must be scheduled with the Production Staff.
9. Any use and/or changing of rigging and equipment must be approved in advance with the Director of Production Services.
10. The visiting company shall not allow nails, tacks, stage screws, or similar articles to be driven or placed in any part of the premises without the approval by the Director of Production Services..
11. Due to the fragile make-up of the stage floor surface, all tape used on the stage must be of light adhesive and must be approved for use by the Director of Production Services.

LOADING DOCK AREA

ACCESS TO THE LOADING DOCK MUST BE COORDINATED WITH THE PRODUCTION MANAGER.

- *The Loading Dock is located at 1010 North W.C. MacInnes Place between Fortune and Tyler streets.
- *MacInnes Place is a two-way street. Trucks will not block the traffic.
- *The Loading Dock is 38" from ground level. There is a forklift available.
- *The dock can accommodate up four semi-trailers depending on availability.
- *There are two 13' x 20' load in doors leading to the receiving area.
- *The receiving area measures 110' wide by 28' deep by 40' high.
- * Direct and level access is available to the Carol Morsani Hall and Ferguson stages.
- *Access to the Jaeb Theater is through a set of double doors measuring 6' wide by 7' high.
- *Please check with the Director of Production Services regarding storage of empty cases, extra equipment, scenery, etc...
- * **PARKING IN THE LOADING DOCK IS BY PERMIT ONLY.**

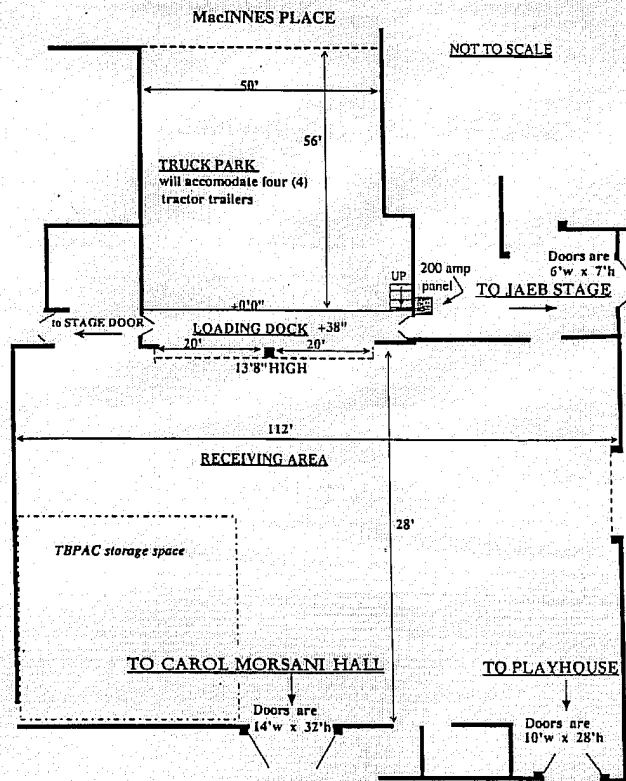

PRODUCTION DEPARTMENT

* Director of Operations	CJ Marshall	(813) 222-6402
* Director of Production Services	Gerard Siegler	(813) 222-1020
* Production Manager	Scott Belowsky	(813) 222-1279
* Production Manager	Melissa Peterson	(813) 222-1027
* Production Manager	Shannon Darby	(813) 222-6437

STAGE LABOR

The David A. Straz, Jr. Center for the Performing Arts is a union facility. THE STRAZ CENTER also has a full-time salaried technical staff which includes:

* Carpenter	Scott Cline	(813) 222-1023
* Fly man	David Reynolds	(813) 222-1025
* Electricians	Jesse Perkins	(813) 222-1999
	Leslie Bindeman	(813) 222-1090
* Sound Technician	Joe Willinger	(813) 222-1026

INTERNATIONAL ALLIANCE OF THEATRICAL STAGE EMPLOYEES LOCAL #321

All labor calls are to go directly to the Center and not the Union.

CAROL MORSANI HALL SEATING

2,610 TOTAL SEATS

ORCHESTRA LEVEL	1387	seats
MEZZANINE LEVEL	459	seats
BALCONY LEVEL	406	seats
GALLERY LEVEL	358	seats
ORCHESTRA PIT #1	62	seats
ORCHESTRA PIT #2	64	seats
ORCHESTRA PIT #3	112	seats

(all pit seats are included in orchestra level count)

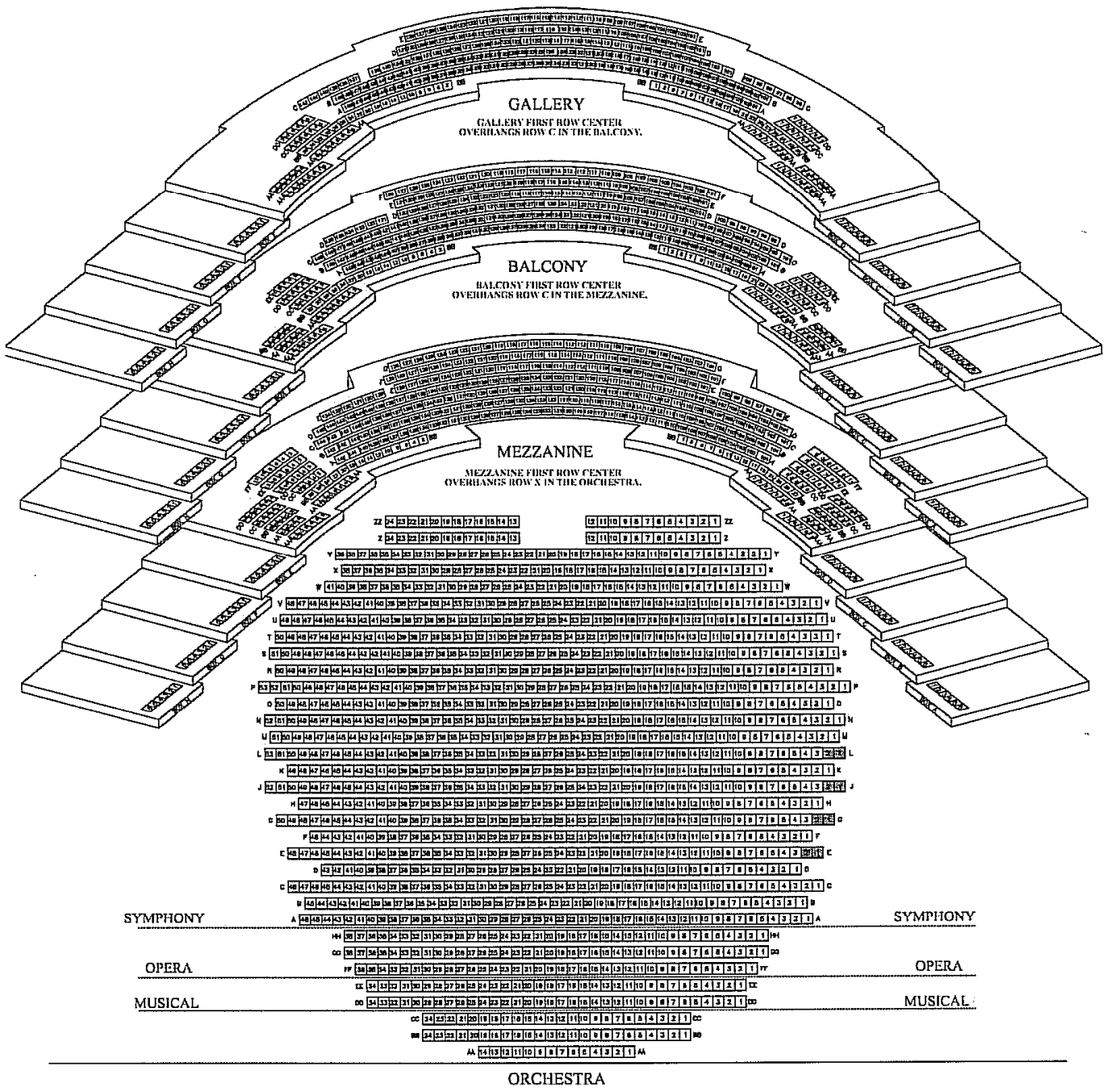

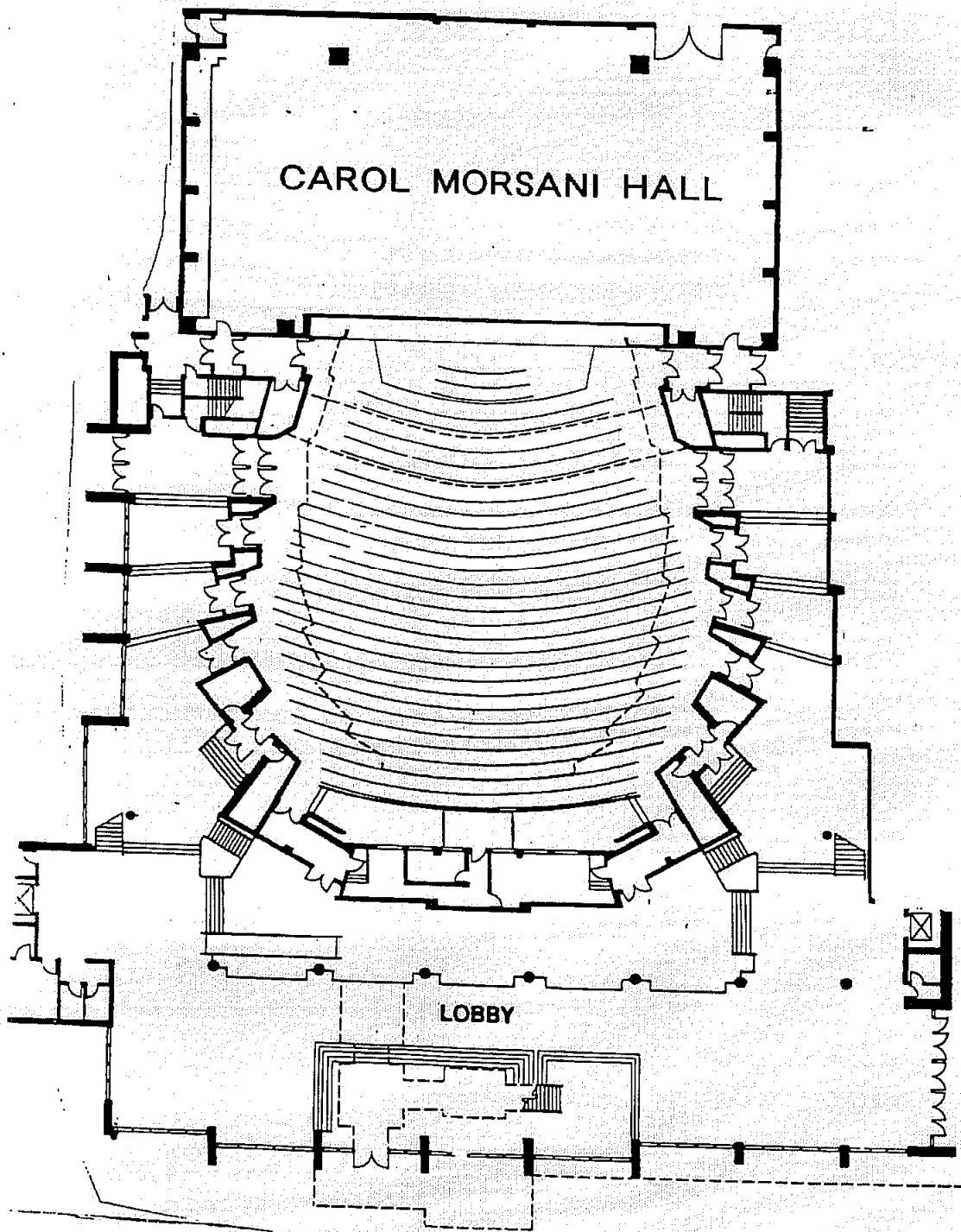

GENERAL INFORMATION

PROSCENIUM OPENING:	60' wide (maximum) - 45' (minimum) Pro Mask Legs 40' high (maximum) - 30' (minimum) Pro Mask Header
STAGE:	70' deep (from plaster line to back wall) 4' deep (from edge of fixed stage to plaster line) 3'-6" (first available line set, #3, from plaster line) 57' deep (last available line set from plaster line)
STAGE LIFTS:	#1 12' deep x 45' wide (curved) #2 8'-6" deep x 65' 6" wide (curved) #3 10'-6" deep x 71' wide (curved) Use of all three lifts equals an area of 2730 square feet. Together the lifts are 36' 3" (from curtain line) and a distance of 40' from center at the widest point of the lifts.
OFF STAGE:	30' wings off left and right
GRID:	100' high-- grid walkway 95' high -- pipes at high trim 4' high -- pipes at lowest trim 2 3/8" -- outside diameter of system pipes 105 single purchase counter-weighted line sets
CONCERT WALL:	60' wide x 40' high x 8" deep 1' down stage of curtain line
LOAD-IN DOOR:	20' wide x 15' high – Loading dock to receiving area 14' wide x 32' high – Receiving area to stage

**STAGE FLOOR IS A ROBBINS BIO-CHANNEL RESILIENT DANCE FLOOR.
IT IS MADE OF MAPLE AND PAINTED BLACK.**

***NOTE:** Please refer to items #10 & 11 in "PRODUCTION RELATED RULES AND REGULATION", page 6, regarding use and care of the stage floor.*

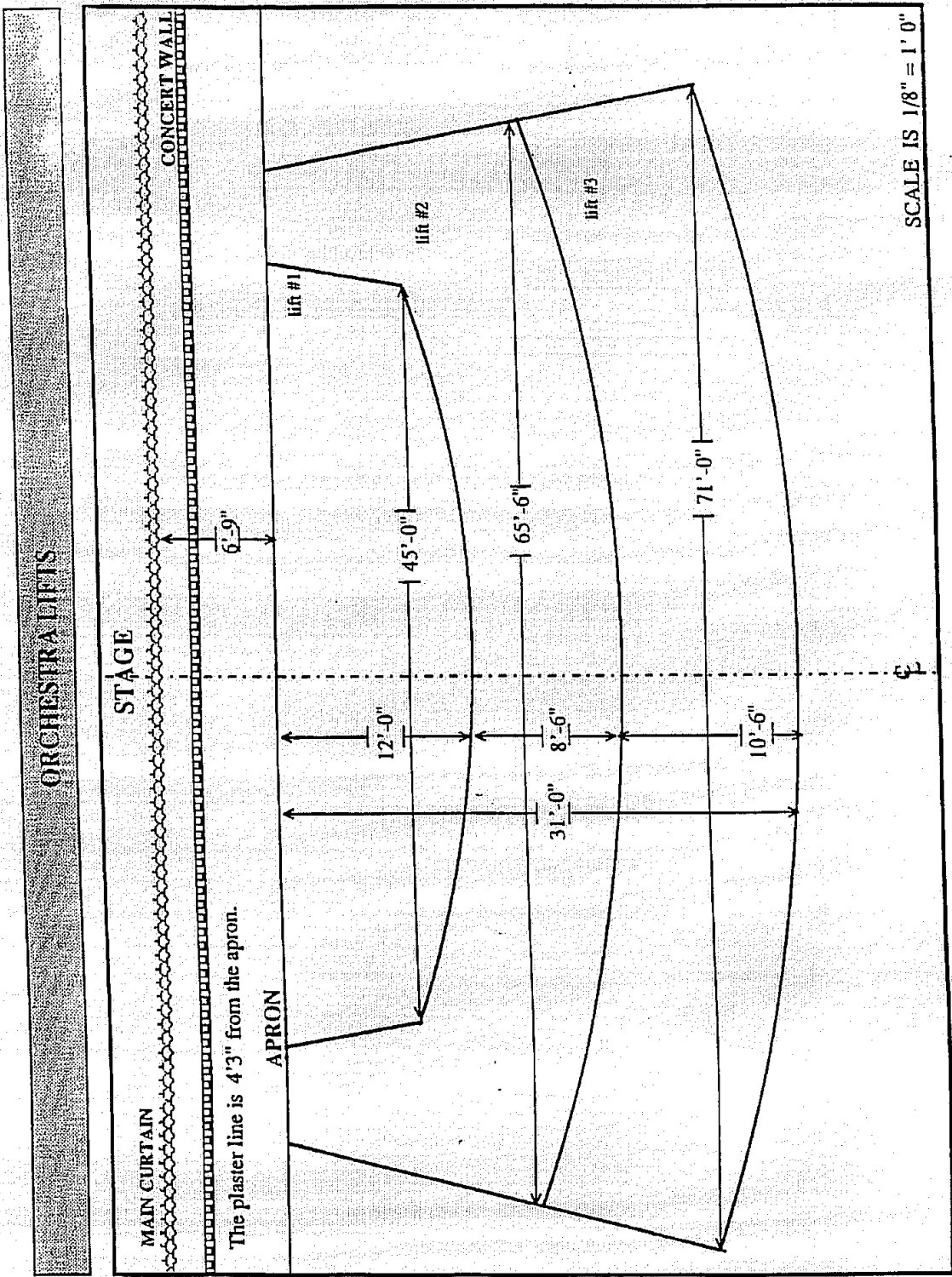

LIFT # 1 accommodates approximately 30 musicians
 LIFTS # 1 & 2 accommodates approximately 75 musicians

RIGGING

CAROL MORSANI HALL has a complete fly system providing 105 single purchase counter-weighted lines, each with an arbor capacity of 2000 lbs. The outside diameter of the pipes is 2 3/8", the inside diameter is 2", and the length is approximately 72'. The line sets are on 6" centers. The concert wall, proscenium headers, and the hard portal legs are permanent fixtures

There are 5 pairs of legs, each is full black velour. The border masking is non-pleated black velour. The main curtain flies in a guillotine direction. The operation of the main curtain requires two people and is located on the stage floor off stage right. The main curtain is pleated and deep red in color.

There is a white color cyclorama located 45'-6" from the curtain line, allowing enough room upstage for crossover space and some storage. There are two 50' x 70' scrims (one black and one white) and two non-pleated blackout drops 45' x 70' that can be moved to any of the available lines.

There is a black traveler located on line set 45, (24'-6" upstage of the curtain line). It is in two panels of 45'w x 40'h each. Moving this curtain from it's location is not advised.

The onstage house lighting consists of four (4) onstage electric pipes, five (5) par strip electrics, and one pipe with medium focus par cans. See Electrics section on page 18 for more information.

All lines (except the main curtain) are controlled from the fly rail gallery located stage right 40' above stage level. The loading gallery is located 95' above stage level and has approximately 10,000 lbs. of available weights. There are some pipe extensions available.

LINE SCHEDULE LINE SCHEDULE

LINE	DISTANCE	UNIT	NOTES
A	0'-7"	CONCERT WALL	8" thick NOT MOVABLE stained wood pattern
B	1'-6"	PRO MASK HEADER	NOT MOVABLE red in color
C	1'-10"	PRO MASK LEGS	NOT MOVABLE red in color
D	2'-3"	HOUSE CURTAIN	NOT MOVABLE red in color
1	2'-8"	BLACK PORTAL HEADER	NOT MOVABLE black in color
2	3'-1"	BLACK PORTAL LEGS	NOT MOVABLE black in color
3	3'-6"		FIRST AVAILABLE PIPE
4	4'-0"		
5	4'-6"		
6	5'-0"	#1 PAR STRIPS	6 sets of Par 64 strips with Lee color #HT 027 & 119, and Rosco #22
7	5'-6"		
8	6'-0"	#1 ELECTRIC	X wash with Lee 137 & 110 and U.S. front wash with Lee 161 & 109 and 14 specials
9	6'-6"		
10	7'-0"		
11	7'-6"		
12	8'-0"		
13	8'-6"		
14	9'-0"		
15	9'-6"		
16	10'-0"		
17	10'-6"	#1 BLACK BORDER	
18	11'-0"	#1 BLACK LEGS	
19	11'-6"	#2 PAR STRIPS	6 sets of Par 64 strips with Lee color #HT 027 & 119, and Rosco #22
20	12'-0"	#2 ELECTRIC	X wash with Lee 137 & 110 and U.S. front wash with Lee 161 & 109 and 2 specials
21	12'-6"		
22	13'-0"		
23	13'-6"		
24	14'-0"		
25	14'-6"		
26	15'-0"		
27	15'-6"		
28	16'-0"		
29	16'-6"		
30	17'-0"		
31	17'-6"		
32	18'-0"	#2 BLACK BORDER	
33	18'-6"	#2 BLACK LEGS	

LINE SCHEDULE

LINE	DISTANCE	UNIT	NOTES
34	19'-0"	#3 PAR STRIPS	6 sets of par 64 strips with Lee color #HT 027 & 119, and Rosco #22
35	19'-6"	#3 ELECTRIC	X wash with Lee 137 & 110, and U.S. front with Lee 161 & 109, and 2 specials
36	20'-0"		
37	20'-6"		
38	21'-0"		
39	21'-6"		
40	22'-0"		
41	22'-6"		
42	23'-0"		
43	23'-6"		
44	24'-0"		
45	24'-6"	BLACK TRAVELER	NOT MOVABLE Full curtain with 2 panels at 45' x 40' each
46	25'-0"		
47	25'-6"	#3 BLACK BORDER	
48	26'-0"	#3 BLACK LEGS	
49	26'-6"	#4 PAR STRIPS	6 sets of Par 64 strips with Lee color #HT 027 & 119, and Rosco #22
50	27'-0"	#4 ELECTRIC	X wash with Lee 137 & 110, and U.S. front with Lee 161 & 109, and 2 specials
51	27'-6"		
52	28'-0"		
53	28'-6"		
54	29'-0"		
55	29'-6"		
56	30'-0"		
57	30'-6"	PAR CAN BACK LIGHT	36 medium flood par cans Blue, Lavender, Magenta, ,Blue Green
58	31'-0"		
59	31'-6"		
60	32'-0"		
61	32'-6"		
62	33'-0"	#4 BLACK BORDER	
63	33'-6"	#4 BLACK LEGS	
64	34'-0"	#5 PAR STRIPS	6 sets of Par 64 strips with Lee color #HT 027 & 119, and Rosco #22
65	34'-6"		
66	35'-0"		
67	35'-6"		
68	36'-0"		
69	36'-6"		

LINE SCHEDULE

LINE	DISTANCE	UNIT	NOTES
70	37'-0"		
71	37'-6"		
72	38'-0"		
73	38'-6"		
74	39'-0"		
75	39'-6"		
76	40'-0"		
77	40'-6"	#5 BLACK BORDER	
78	41'-0"	#5 BLACK LEGS	
79	41'-6"	LOWER CYC STRIPS	9 sets of T-3 units with Lee colors
		NOT MOVABLE	#HT027 & 119, and Rosco #22
80	42'-0"		
81	42'-6"	UPPER CYC STRIPS	9 sets of T-3 units with Lee colors
		NOT MOVABLE	#HT027 & 119, and Rosco #22
82	43'-0"		
83	43'-6"		
84	44'-0"		
85	44'-6"		
86	45'-0"		
87	45'-6"	CYCLORAMA	50' x 70'
88	46'-0"	BLACK OUT DROP	45' x 70'
89	46'-6"		
90	47'-0"		
91	47'-6"		
92	48'-0"		
93	48'-6"		
94	49'-0"		
95	49'-6"		
96	50'-0"		
97	50'-6"		
98	51'-0"		
99	51'-6"		
100	52'-0"		
101	52'-6"		
102	53'-0"		
103	53'-6"		
104	54'-0"		
105	54'-6"		

ELECTRICS

ONSTAGE POSITIONS

- There are four electric pipes
- They offer down and cross washes.
- All onstage Lekos are ETC source 4s 750w. All Fresnels are ETC Parnels
- The cyclorama is lit from overhead and a ground row. Instruments are Altman T-3 and are circuited as a three color wash.
- There are five lines of par strips that contain six Par 64 strips with Lee color #HT 027 & 119 and Rosco #22.
- There are five electric ladders stage left and five stage right.
- There are ten booms available only upon request.
- There are specials on electrics #1 - 4 available for focus.
- All (except the first) electrics are under-hung on 1 1/2" pipe.
- Stripping the electrics is not advised.
- For more information on the electric pipes please see the hanging schedule on page 14.
- The onstage washes are pre-focused and circuited. If altered, all changes will need to be re-focused after the event.

ROAD POWER

- Located offstage left.
- There are three disconnect panels, 400 amp per leg, three phase each.
There is one 200 amp for sound.
- The road circuit transfer panel which offers access to the front of the house circuits is located in the same area. Front of house circuits are also accessible by DMX.
NOTE: All F.O.H. circuits do not appear at the transfer panel.

LIGHTING CONTROL

A dimmer-per-circuit system is used with 761 circuits. There are 706 2.4k dimmers and 55 6k 60 amp dimmers. Some lamps are two-fered. All circuits are stage pin connectors with ground, and are controlled by an ETC EOS Console.

Dimmers are Strand CD 80s. Converters are used to convert console DMX to dimmer AMX.

ELECTRICS

FRONT OF HOUSE POSITIONS

There are three balcony rail positions front of house which contain permanently installed ETC Source 4 instruments.

BALCONY 1 – Located on the mezzanine level. Used as needed. No pre hung fixtures.

BALCONY 2 - Located on the balcony level and focused for a four-color wash. Gel colors are Lee 137 Special Lavender, 161 Slate Blue, 147 Apricot, and 110 Middle Rose. There are twenty-four 10° source 4 750 kw Lekos which take 12" frames.

BALCONY 3 - Located on the gallery level and focused for a general wash. Gels are Lee 110 Middle Rose and 161 Slate Blue. There are twelve 5° source 4 750 kw lekoes which take 14" frames.

There are upper and lower box booms. Box booms are mounted horizontally above box seats. The upper box booms are extremely difficult to access.

LOWER BOX BOOMS - Located on balcony level. It repeats left and right and focused for a two-color wash. Gels are 137 Special Lavender and 147 Apricot. The instruments are six 19° & four 14° ETC Source 4 Lekos which take 7" frames. There are two instruments on each side available for specials.

UPPER BOX BOOMS - Located on gallery level. It repeats left and right and is focused for a 2 color wash. Gels are 107 Light Rose and 161 Slate Blue. There are six 19° Source & four 14° 4 Lekos which take 7" frames.

GALLERY BOX BOOMS – Located on gallery level. It repeats left and right and is focused as curtain warmers. L 106 primary red.

- All instruments are 20 amp pin connectors
- The F.O.H. washes are all pre-focused and circuited. If altered, all changes will need to be refocused after the event.
- There are some free circuits available.
- Balcony rail fixtures can not be moved without great difficulty and time.

FOLLOW SPOT BOOTH - Located 140' from the plaster line, it is equipped with four Lycian 3kw. These instruments are available for rent and are permanently housed in the follow spot booth. *They can not be moved to any other location for any reason.*

LIGHT PLOT AND CIRCUIT PLOT AVAILABLE UPON REQUEST

COLOR LIST

All color is Lee except for Rosco Lux as noted.

CURTAIN WARMERS	106	Primary Red
FRONT WASH	161	Slate Blue
	110	Middle Rose
	137	Special Lavender
	147	Apricot
UPPER BOX BOOMS LEFT & RIGHT	107	Light Rose
	161	Slate Blue
LOWER BOX BOOMS LEFT & RIGHT	137	Special Lavender
	147	Apricot
STAGE LEFT X-WASH	137	Special Lavender
STAGE RIGHT X-WASH	110	Middle Rose
LADDERS	R 68	Parry Sky Blue
	R 31	Salmon Pink
	R 58	Deep Lavender
ONSTAGE FRESNELS	161	Slate Blue
	109	Dark Pink
PAR 64 STRIP LIGHTS	R22	Deep Amber
	119	Dark Blue
	HT 027	Medium Red
CYCLORAMA & GROUND ROW	R22	Deep Amber
	119	Dark Blue
	HT 027	Medium Red

SOUND

MAIN P.A. SYSTEM

- 1 Yamaha CL5 Console
- 1 XTA DP 224 4 way for Center / Sub
- 1 XTA DP 226 2x3 way for L/R

CENTRAL CLUSTER

- 4 - way central cluster loudspeakers are JBL & Eastern Acoustical Work
- 5 JBL bass bins
- 2 JBL sub-bass bins
- 8 JBL 2445 horn drivers
- 4 JBL 4850 full range speakers
- 5 EAW mid-bins JBL loaded
- 4 QSC power light 1.8 amps
- 9 QSC power light 2 PL 230 amps

AUXILIARY EQUIPMENT

The following list of equipment is located in a booth in the rear of the house (orchestra level) 122' from the plaster line of the stage. All equipment is patchable

- 1 Clark Technical DN 360 stereo 1/3 octave equalizer
- 1 Yamaha Pro R3 digital reverb
- 1 Tascam 122 cassette deck
- 2 DBX 166 compressor limiter
- Behringer composer MDX 2100 compressor limiter
- 1 Yamaha SPX 900 digital reverb unit
- 1 Tascam CD-301 compact disc player
- Tascam CDRW 900 CD burner/player
- Tascam DA-20MKII DAT record/play

The following equipment list is located behind the cockpit in a sound proof booth.

- 4 QSC 3500 power amps & 1 QSC power light 2 PL 230 - patchable for stage fold back
- 1 Custom 36 input 4-way active splitter system. Jensen transformer balanced.

SOUND

PROGRAM/PAGE SYSTEM

The backstage program/page system is controlled from the Central communications room located in sound room # 3.

The system feeds the backstage hallways. The dressing rooms are equipped with volume controls .

ONSTAGE COMMUNICATIONS

A RTS intercom system is available with permanent stations in the stage manager's console off stage right and all booths. Patch points are available in all needed locations. RTS belt packs are available with Beyer DT 108 headsets. Patchable tie lines are available in all booths, the orchestra pit, and the fly rail for portable intercom systems. The system is NOT compatible with Clearcom systems.

ROAD POWER

- Located off stage left
- One 200 amp 3 phase disconnect panel

ADDITIONAL SOUND EQUIPMENT

- A Sennheiser infra-red system for the hearing impaired is provided
- A Custom 24 volt cue light system is available in all needed locations. Cue lights are controlled at the stage manager's panel which is off stage right.
- There is a permanently installed front of house closed circuit camera for video monitor at the stage managers console. There is also a video camera for lobby late seating monitors.

OUTBOARD AUDIO EQUIPMENT

The following is a list of outboard audio equipment in the Center which is not permanently assigned to a specific theater. Requests for additional equipment must be received by the Production Department no later than two weeks prior to the load-in. A nominal charge may be incurred on some of the equipment. All equipment is on a first come first serve basis.

MICROPHONES

- * Shure SM 58
- * Shure SM 57
- * Shure SM 59
- * Shure SM 78
- * AKG 460 with AKG CK 1 head
- * AKG 535
- * Sennheiser 441
- * Sennheiser 421
- * Crown PZM
- * Crown PCC
- * Brooke Siren direct boxes
- * We have a large assortment of both straight and boom stands

SPEAKERS

- * JBL 4604 monitor speakers
- * JBL 4602 monitor speakers
- * JBL 4698 monitors
- * EV 1503 monitors
- * TOA personal monitors (hot spots)
- * Loudspeaker systems include appropriate amps, controllers, and cable.

ORCHESTRA REINFORCEMENT

There are adjustable acoustical treatments and settings available in all theaters of the David A. Straz, Jr. Center for the Performing Arts.

The following are in the Carol Morsani Hall:

- There are movable curtains on all exposed house walls.
- There is an adjustable wood ceiling baffle (canopy) with an operating range from 42' to 54' from stage level.
- An acoustical wall, acting as an orchestra shell, that is 8" thick, located at the proscenium arch which is lowered for orchestras performing downstage of the arch on the lifts.

WARDROBE ROOM AND DRESSING ROOMS

There is one wardrobe room area located stage level on stage right. The room is 27' wide and 37' long. There are three washers and three dryers. There are also irons, ironing boards, and portable steamers.

Use of the wardrobe room and its inventory are available only when a member of the I.A.T.S.E. Local #321 wardrobe personnel is present. Scheduling of this may be done through the Production Department.

There are a total of 14 dressing rooms, one of which is a star dressing room furnished with a sectional sofa, chairs and tables. Each dressing room is equipped with a duplex outlet at each station, a full length mirror, one portable rack, and a stage monitor feed in each dressing room.

ROOM #	# OF STATIONS	# OF SHOWERS	# OF TOILETS	# OF SINKS
1	Four	one	One	one
2	Four	one	One	one
3	Four	one	One	one
4	Seventeen	three	Three	three
4a	Eight	none	None	none
5	Eighteen	two	Two	three
6	Four	one	One	one
7	Four	one	One	one
8	Four	one	One	one
9	Eighteen	three	Three	three
9a	Eight	none	None	none
10*	Eleven	One	Two	two
11	Nine	One	Two	two
12	Nine	One	Two	two
14	Nine	One	Two	two
15	One	One	One	one

Please note that rooms 4, 4a, 9 and 9a are all adjoining and can be used in several configurations.

*Please note that dressing room 10 is equipped with a wheelchair accessible bathroom.

There is a vending area located off the dressing room hallway. Please note that this is a common area for the David A. Straz, Jr. Center for the Performing Arts. It is not for the exclusive use of Carol Morsani Hall.

NOTE: NO SMOKING, FOOD, OR DRINK IS ALLOWED ON STAGE.

CAROL MORSANI HALL BACKSTAGE & STAGE DOOR AREA - 1st floor

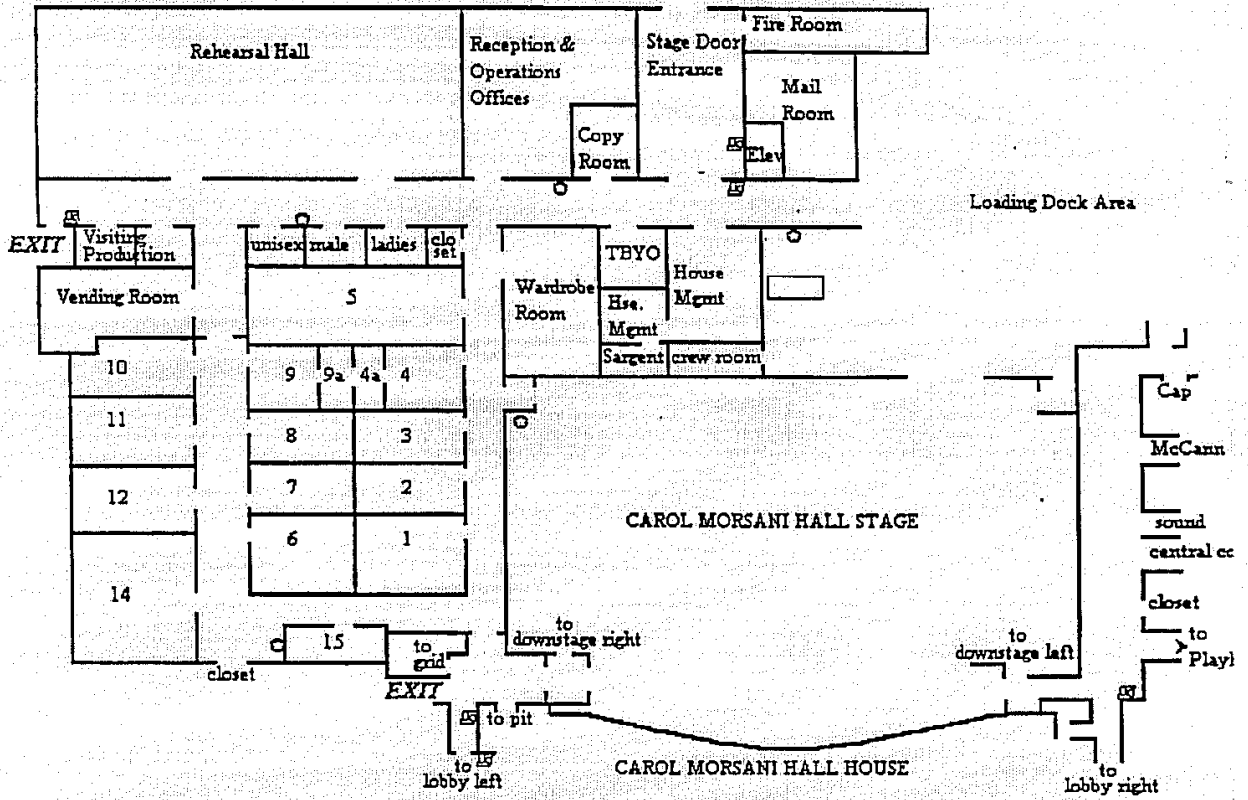

☒ = Alarm pull station

⊗ = Fire hose cabinet

NOT TO SCALE